

# 45° Pillow Block Bearing

## 1010U

Aziz Bhayani, Adam Chmelauskas, Gabriel Lefort-Gambioli

TenTon Robotics, West Vancouver, BC

Explanation:

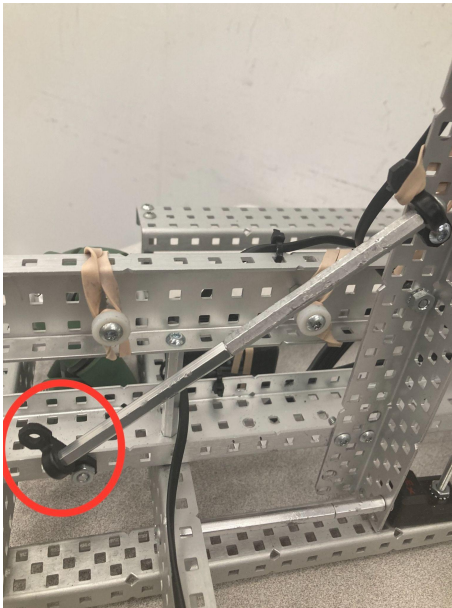

We have used many bracket braces on our robot, to strengthen the structure. While using normal pillow blocks is doable, we wanted to come up with a stronger design, one that can still have two screws in a C-channel.

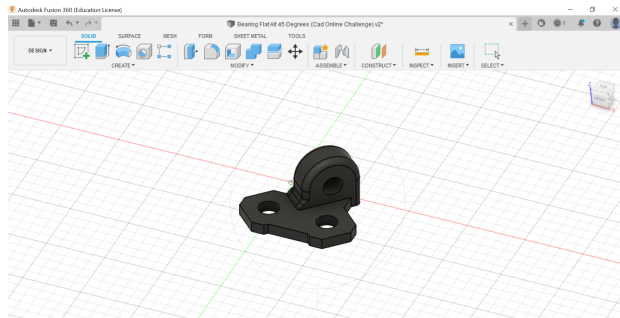

This is essentially a normal pillow block, except one of the mounting holes was moved in a way that lets one screw screws in both holes, making it much more secure.